

ABSTRACT OF COST OF EARTH FILLING IN OPEN COURT YARD OF D.A.V. PUBLIC SCHOOL, PURABSARAI, MUNGER, BIHAR.						
Sl.No.	S.O.R.	DESCRIPTION	Qty.			
		(1) EARTH FILLING IN OPEN COURT YARD				
		Area of open court yard = $16417.77 - 13'-6'' \times 11'-6'' - 7'-0'' \times 17'-4'' = 16141.21$ Sft (1500.11 Sqm)				
		SECTION-I (EARTH WORK / SAND FILLING)				
1	2.1.	Earth work in surface excavation not exceeding 30 cm in depth but exceeding 1.5 m in width as well as 10sqm on plan including disposal of excavated earth upto 50 m and lift upto 1.5 m, disposed earth to be levelled and neatly dressed.				
	2.1.1	All kinds of soil.	1500.11	Sqm		
2	2.2	Earth work in rough excavation, banking excavated earth in layer not exceeding 20 cm in depth, breaking clods watering, rolling each layer with 1/2 tonne roller or wooden or steel rammers and rolling every third and topmost layer with power roller of minium 8 tonnes and dressing up in embankments for roads, flood banks, marginal banks and guide banks or filling up ground depressions, lead upto 50 m and lift upto 1.5 m				
	2.2.1	All kinds of soil.	608.33	Cum		
		TOTAL				
		ROUND UP				
		Cost of construction per S.Ft.				

- NOTE:-
- EXCEPT GEN. AREA THE EARTH FILLING WILL BE DONE WITH PROPER LEVEL.
 - GROUND WILL BE CUT FROM 8" TO 12" IN LEVELED WITH MAINTAINING SLOPE OF 4" FROM NEW BLOCK TO ROAD SIDE COMPOUND WALL. BEFORE CUTTING PROPER LEVEL OF EXISTING EARTH MUST BE CHECKED.
 - GOOD EARTH FOR GRASS WILL BE FILLED UP IN 1'-4" DEPTH AS PER LEVEL AND SLOPE TO MAINTAIN.
 - FINAL COMPACTED FILLED EARTH LEVEL TOWARDS THE COMPOUND WALL WILL BE 4" ABOVE ROAD LEVEL.

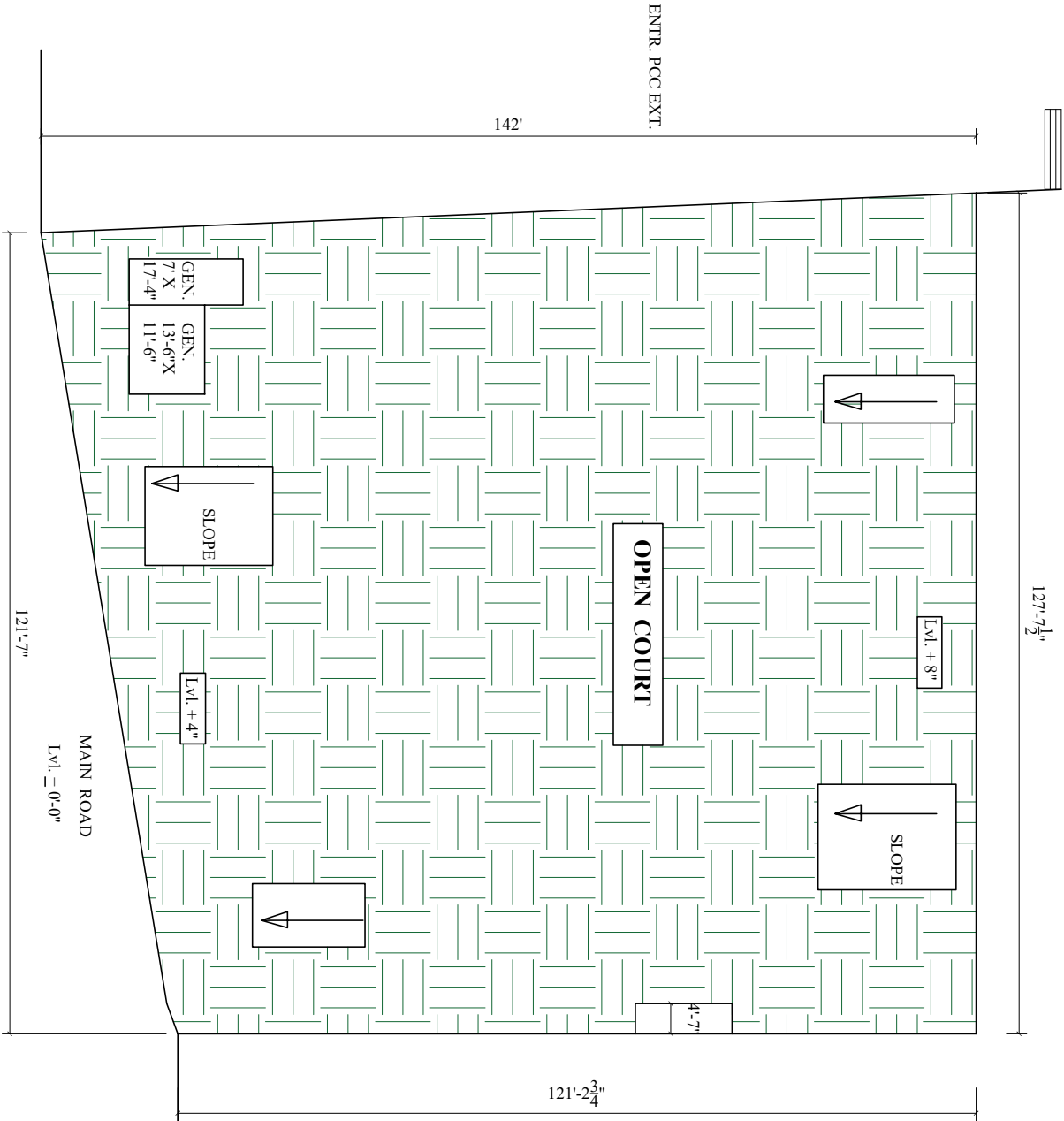

AREA OF OPEN COURT = 16417.77 SFT. -13'-6"X11'-6"-7'X17'-4"= 16141.21 SFT.

PROJECT	PROPOSED EARTH FILLING IN OPEN COURT YARD OF D.A.V. PUBLIC SCHOOL, PURAB SARAI, MUNGER, BIHAR.		
	DRG. NO.-01	DATE	<div>archgroup</div> <div>architects, engineers, interior designers, 507(A),VASTU VIHAR,PH-6,AIIMS-1, NH-139, NAUBATPUR ROAD, BHUSAULA DANAPUR, PATNA, BIHAR. PIN-801505. M-9430001170.</div>
	TITLE	OCT.-25	

LAY OUT PLAN

(SOIL FILLING)